

除非同意，严禁复制、散发、披露或以此文件及其内容进行买卖交易，任何违背此条
令者需承担全部法律责任，保留所有权利，将制定专利权属已注册的设计所有权。

Unless it has been agreed otherwise it is strictly forbidden to copy distribute,
disclose or trade this document or it's contents. Anybody in breach of this ban
will be held liable for full compensation. All right's reserved, especially
the right for patent or registered design lodgement.

A-A Rotate

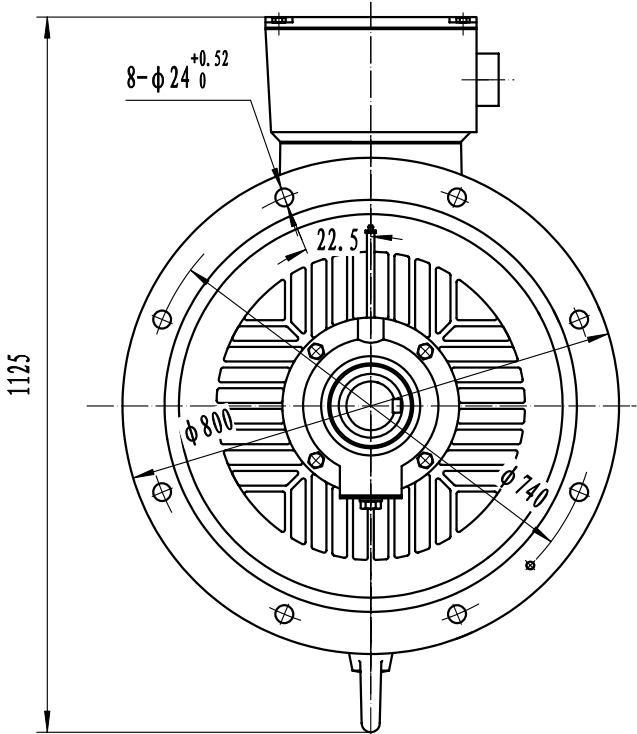
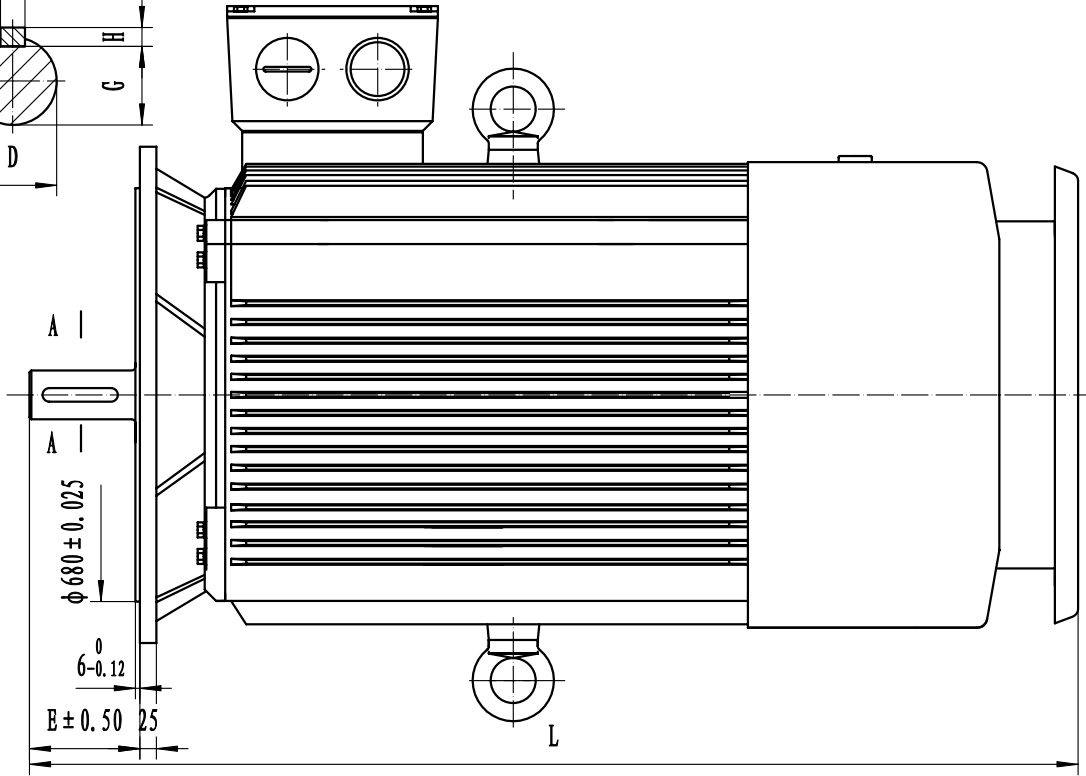
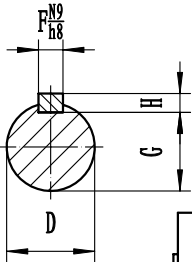

Type	Power (kW)	D	E	F	H	G	L
1LG0353-2AC	220	$\phi 75^{+0.030}_{+0.011}$	140 ± 0.5	20	$12^{-0}_{-0.11}$	$67.5^{-0}_{-0.20}$	1580
1LG0354-2AC	250						
1LG0356-2AC	280						
1LG0357-2AC	315						
1LG0353-4AB	220	$\phi 95^{+0.035}_{+0.013}$	170 ± 0.50	25	$14^{-0}_{-0.11}$	$86^{-0}_{-0.20}$	1610
1LG0354-4AB	250						
1LG0356-4AB	280						
1LG0357-4AB	315						
1LG0353-6AB	160						
1LG0354-6AB	185						
1LG0355-6AB	200						
1LG0356-6AB	220						

注：电机（指实物）安装尺寸符合图中尺寸，外形尺寸不大于图中尺寸。

Note: Dimensions of mounting shall accord with drawing's dimensions, outline dimensions shall not exceed the drawing's dimensions.

							Siemens Standard Motors Ltd.		
标记	处数	分区	更改文件号	签名	日期		1LG0-355 (V1)		
设计	孙梅	20080724	标准化				阶段标记	重量	比例
校对			审定						
审核	王庆中	20080725					B		1:7
工艺			批准				共	张	第 张

借(通)用件登记

旧底图总号

底图总号

签 字

日 期